



# SITESCAPES

P.O. Box 22326  
Lincoln, NE 68542

PF: 402/421-9464  
FX: 402/421-9479

WEBSITE: [www.sitescapesonline.com](http://www.sitescapesonline.com)  
E-MAIL: [info@sitescapesonline.com](mailto:info@sitescapesonline.com)

TITLE *QUARRYVIEW*  
*PEDESTAL SEATING*

PRODUCT NO.  
*QV1-G60J60G*

INCH TOLERANCES U.O.S.

FRACTION--  $\pm 1/16"$   
ANG-----  $\pm 1^\circ$

THE INFORMATION CONTAINED IN THIS DRAWING IS  
THE SOLE PROPERTY OF SITESCAPES, INC. ANY  
REPRODUCTION IN PART OR AS A WHOLE WITHOUT  
THE WRITTEN PERMISSION OF SITESCAPES, INC.  
IS PROHIBITED.

\*Available with Dry Creek, Nantucket, or Pagosa Springs stone veneers

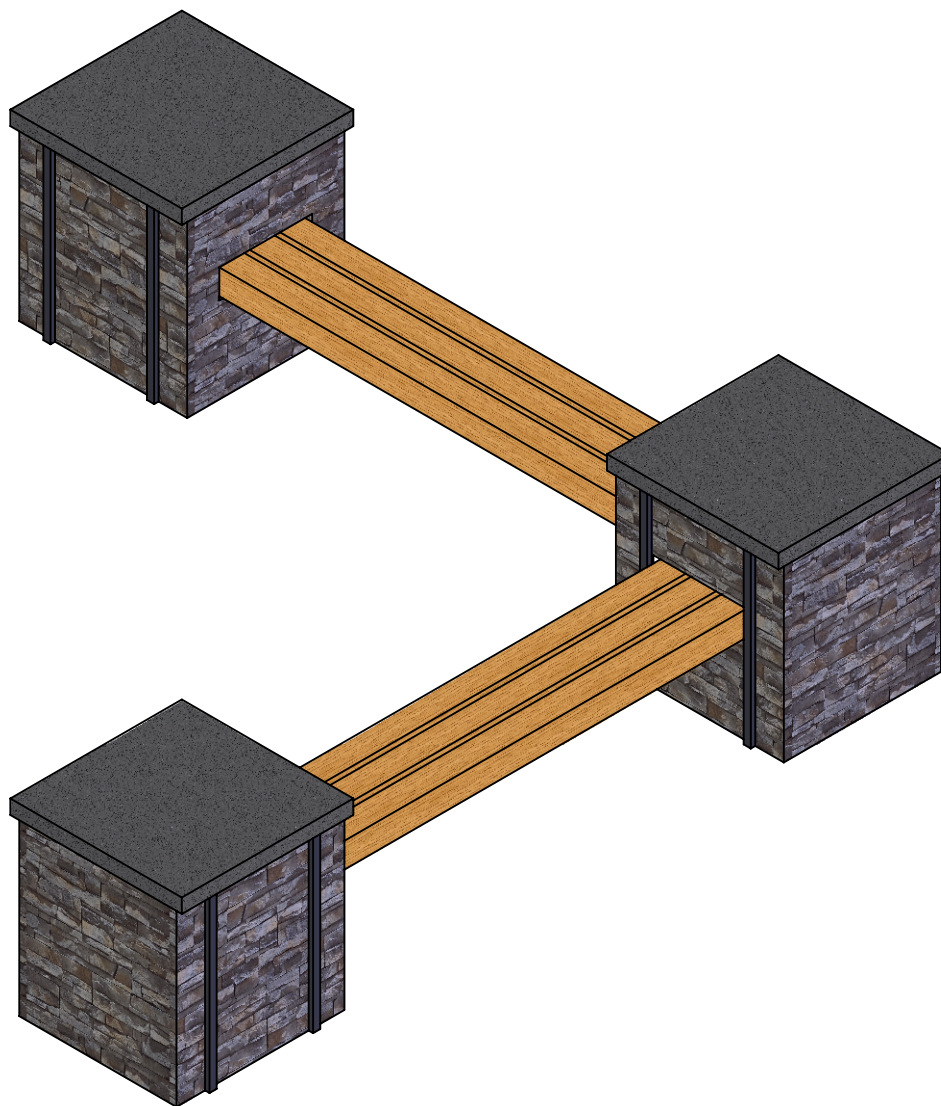



# SITESCAPES

P.O. Box 22326  
Lincoln, NE 68542

PF: 402/421-9464  
FX: 402/421-9479

WEBSITE: [www.sitescapesonline.com](http://www.sitescapesonline.com)  
E-MAIL: [info@sitescapesonline.com](mailto:info@sitescapesonline.com)

TITLE *QUARRYVIEW*  
*PEDESTAL SEATING*

PRODUCT NO.  
*QV1-G60J60G*

INCH TOLERANCES U.O.S.

FRACTION--  $\pm 1/16"$   
ANG-----  $\pm 1^\circ$

THE INFORMATION CONTAINED IN THIS DRAWING IS THE SOLE PROPERTY OF SITESCAPES, INC. ANY REPRODUCTION IN PART OR AS A WHOLE WITHOUT THE WRITTEN PERMISSION OF SITESCAPES, INC. IS PROHIBITED.

\*Available with Dry Creek, Nantucket, or Pagosa Springs stone veneers

#### MATERIALS LIST:

- (1) Stone Veneer
- (2) Pedestal Frame - 1 1/2" Sq. Steel Tubing
- (3) Seat Slats - 4" x 4" Nominal Cedar, Ipe, or Recycled Plastic
- (4) Leveling Feet

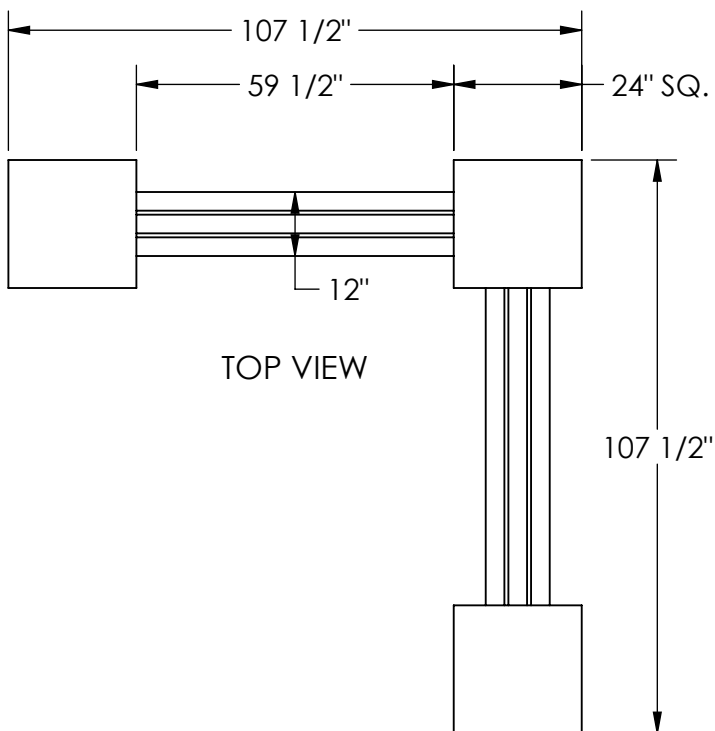

TOP VIEW

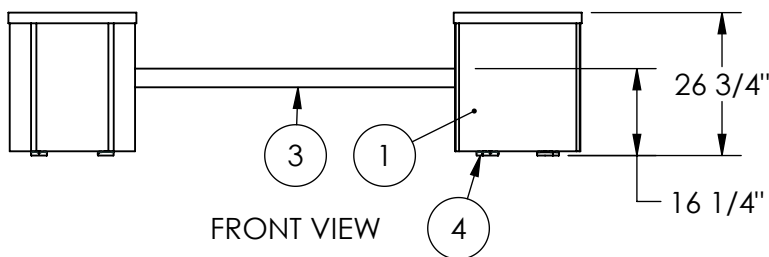
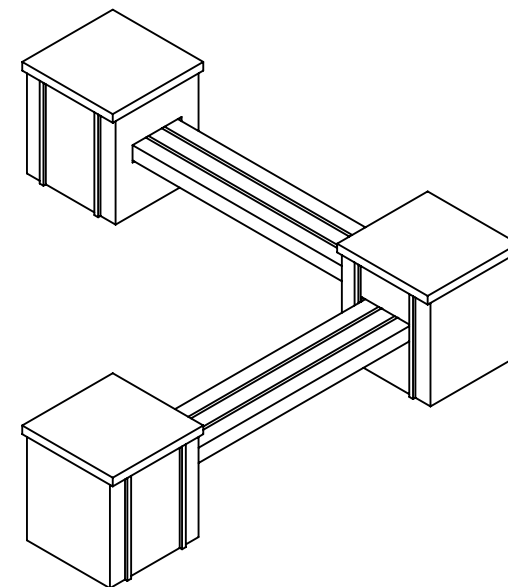

FRONT VIEW

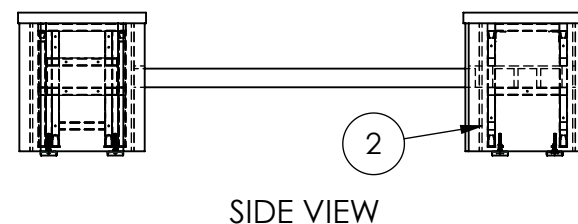

SIDE VIEW